

SKYWAY

SkyWay Linear City in Abu Dhabi





Linear City is a cluster-type urban settlement, where the surface of the earth is meant for pedestrians and green plants, while transport, energy and information networks are elevated above the ground on the "second level".



Line City concept for Abu Dhabi was developed in accordance with the emirate's objectives stipulated by Abu Dhabi Economic Vision 2030

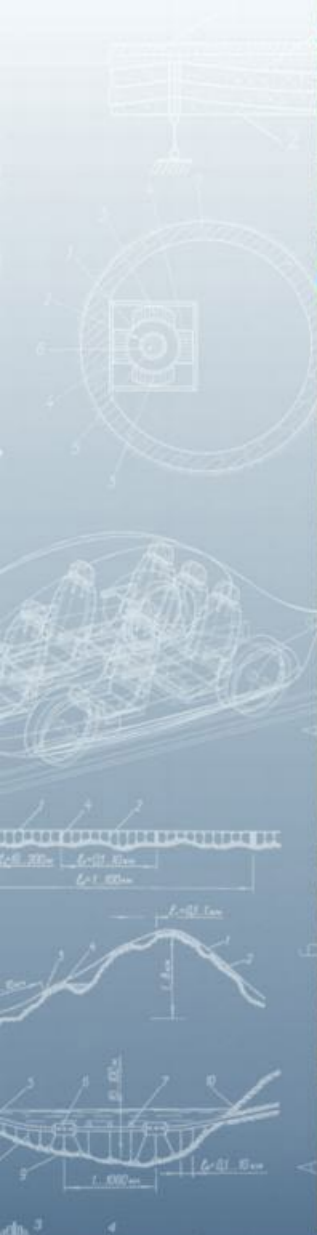



The horizontal lifts connect the neighboring high-rise buildings, settlements, residential, shopping, entertainment and other clusters, allowing for comfortable transit within a few minutes





There is only one mode of transportation in the city are horizontal lifts connecting the high-rise towers, spaced at 500 meters and more



Two types of SkyWay transport in the Linear City



Linear City marine properties are connected by horizontal lifts offering fast and smooth access to hotels, leisure centers and residential apartments

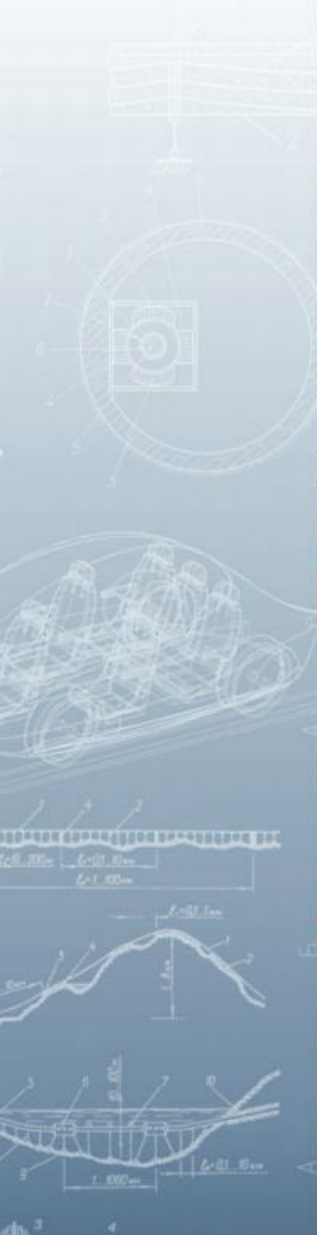



Two-level transfer station in high-rise building

The innovative Linear city approach to urban planning offers a number of advantages over the traditional city building and effectively addresses the key challenges the Abu Dhabi Department of Transport is currently facing





Benefits offered by SkyWay Linear City:

- reducing the cost of construction of roads;
- reducing the cost of maintenance of roads;
- elimination of public transport accidents;
- elimination of traffic congestion in the city;
- restoration of the environment in the city.

SkyWay transport and infrastructure technologies underpinning the Linear City meet all the key requirements of the Estidama national development system

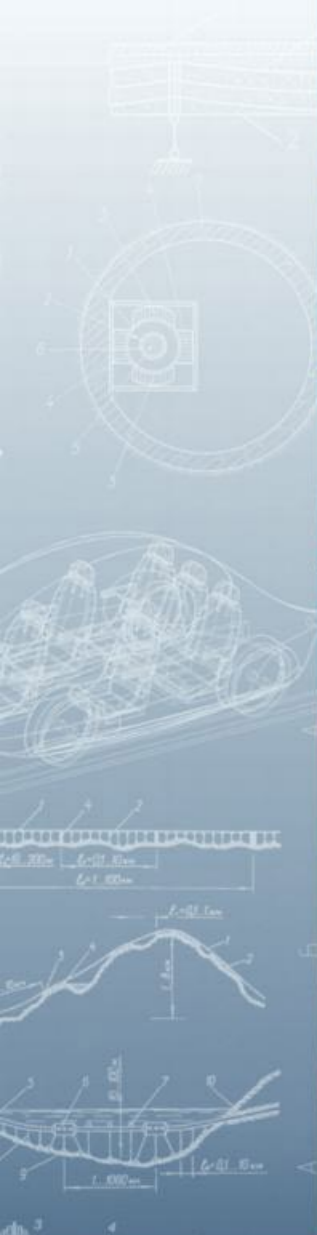

Tower stations located off the shore (on the pile foundation) feature an above-water terrace with a park created on the layer of fertile soil





Comfortable, rapid and inexpensive transport connection between the neighboring islands with SkyWay horizontal lifts going through high-rise buildings



National Park on the Al Hudayriat Island with SkyWay Linear Cities around the perimeter of the island and off the shore (2019)



Eco-city on the Al Hudayriat Island with the jungle and the SkyWay linear city off the shore (2019)

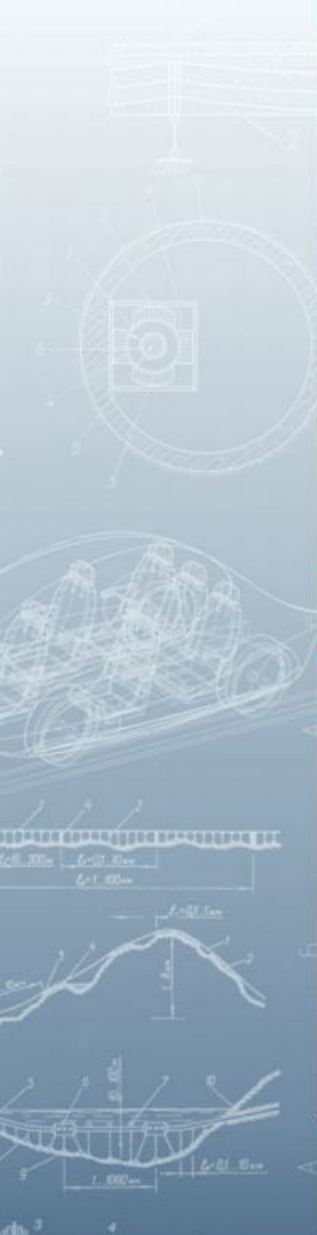

Cluster-type Eco-city on the Al Hudayriat Island with Skyway Linear City off the shore (2019)

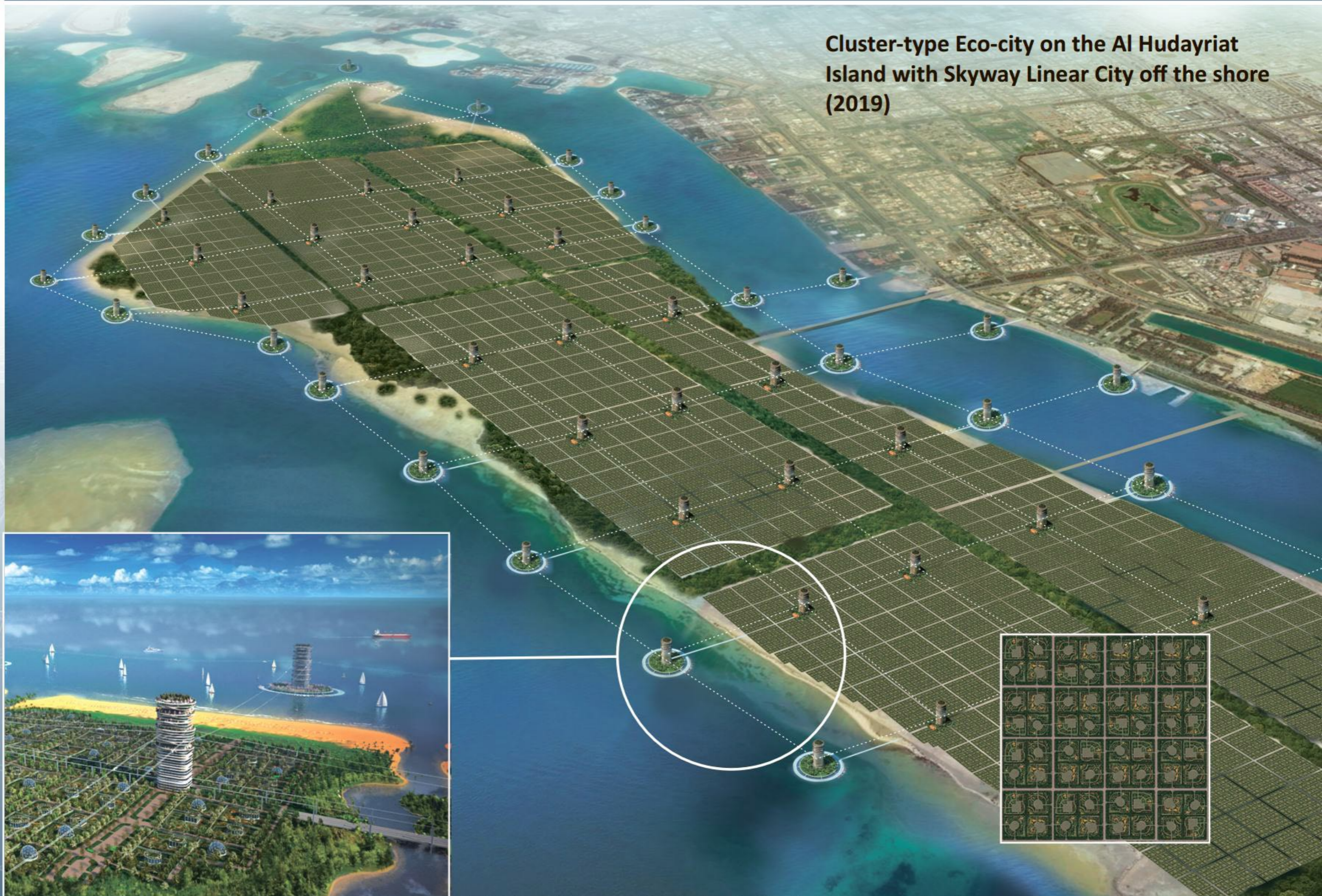

Cluster-type Eco-city on the Al Hudayriat Island with jungles and Skyway Linear City off the shore (2019)



Grade-separated SkyWay stations

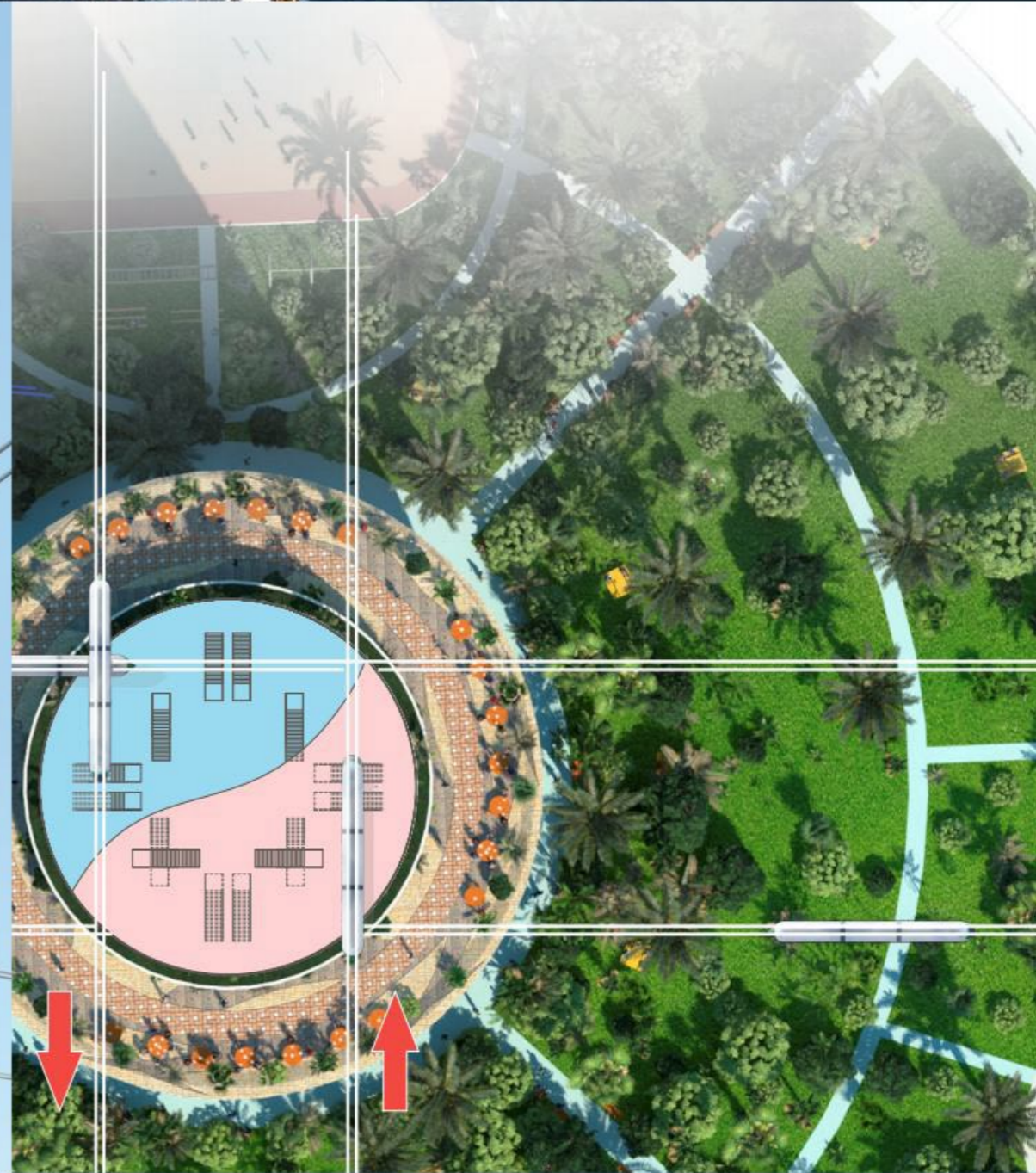
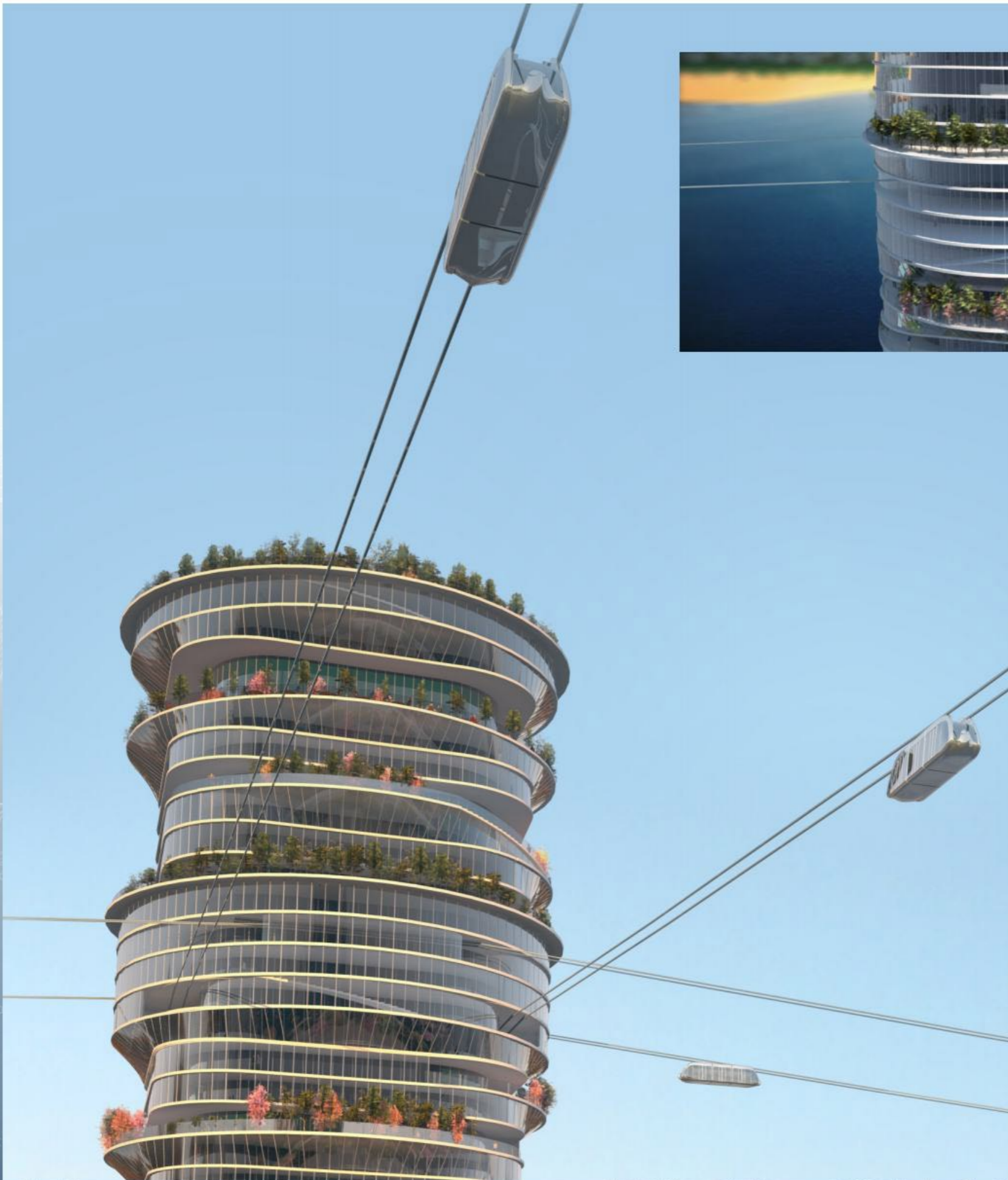

Passenger unibus may employ different types of drive: electric motors, internal combustion engines, including turboprops and hybrid drive systems



In terms of energy consumption the slacking track is about 18 times more efficient than the same stretch of straight track

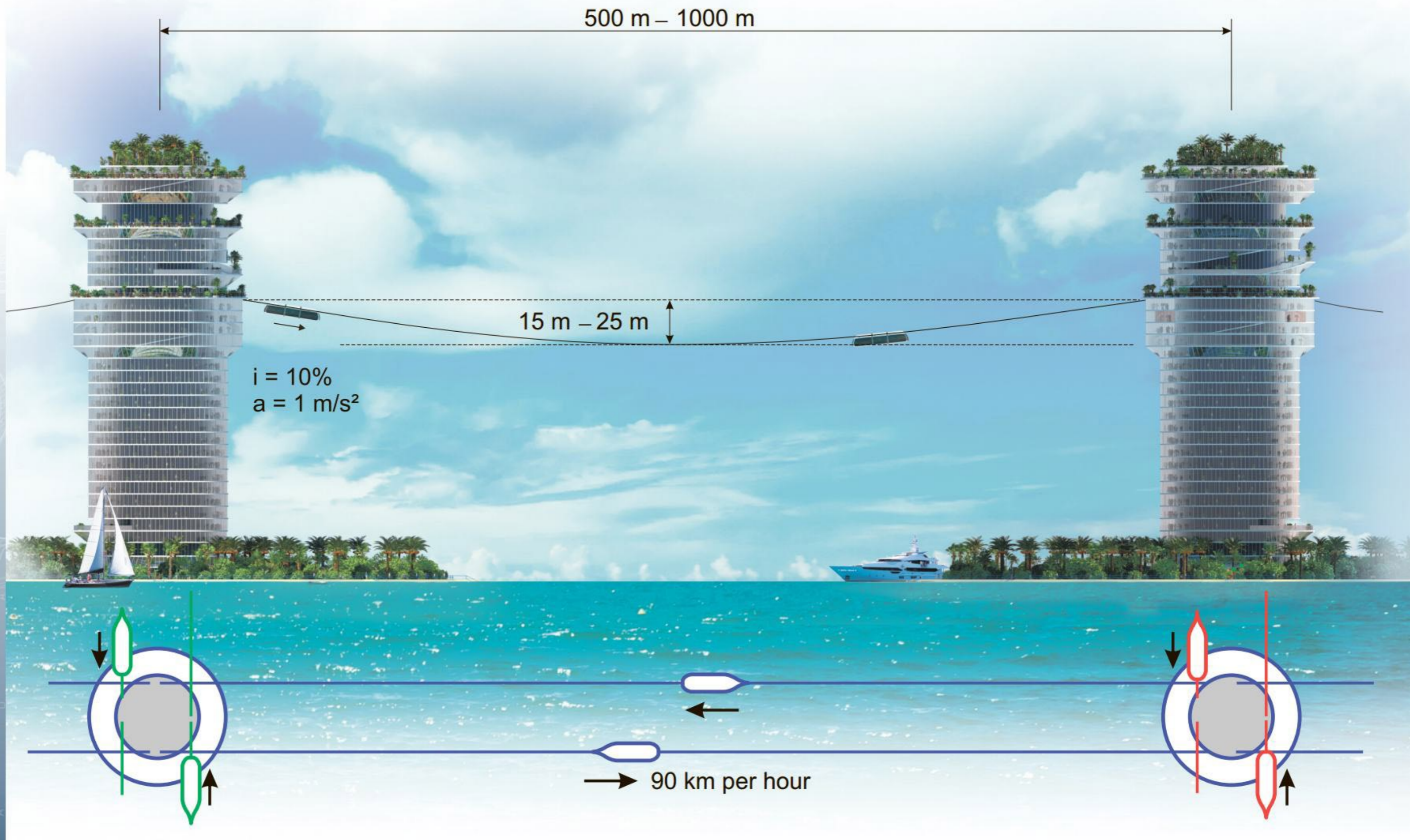



The basic principle of the construction of each infrastructure cluster is that it is a pedestrian quarter, in which comfortable low-rise buildings are put between the multi-functional high-rise buildings connected by a horizontal lift, with widespread landscaping of urban areas

Environmental benefits of the green roof



Cleaner air,
capturing dust and
harmful substances



Better microclimate



Flora and fauna



Sound-cancelling
and noise elimination



Comparison of the cost of one square meter of asphalt paving and of one square meter of restored soil

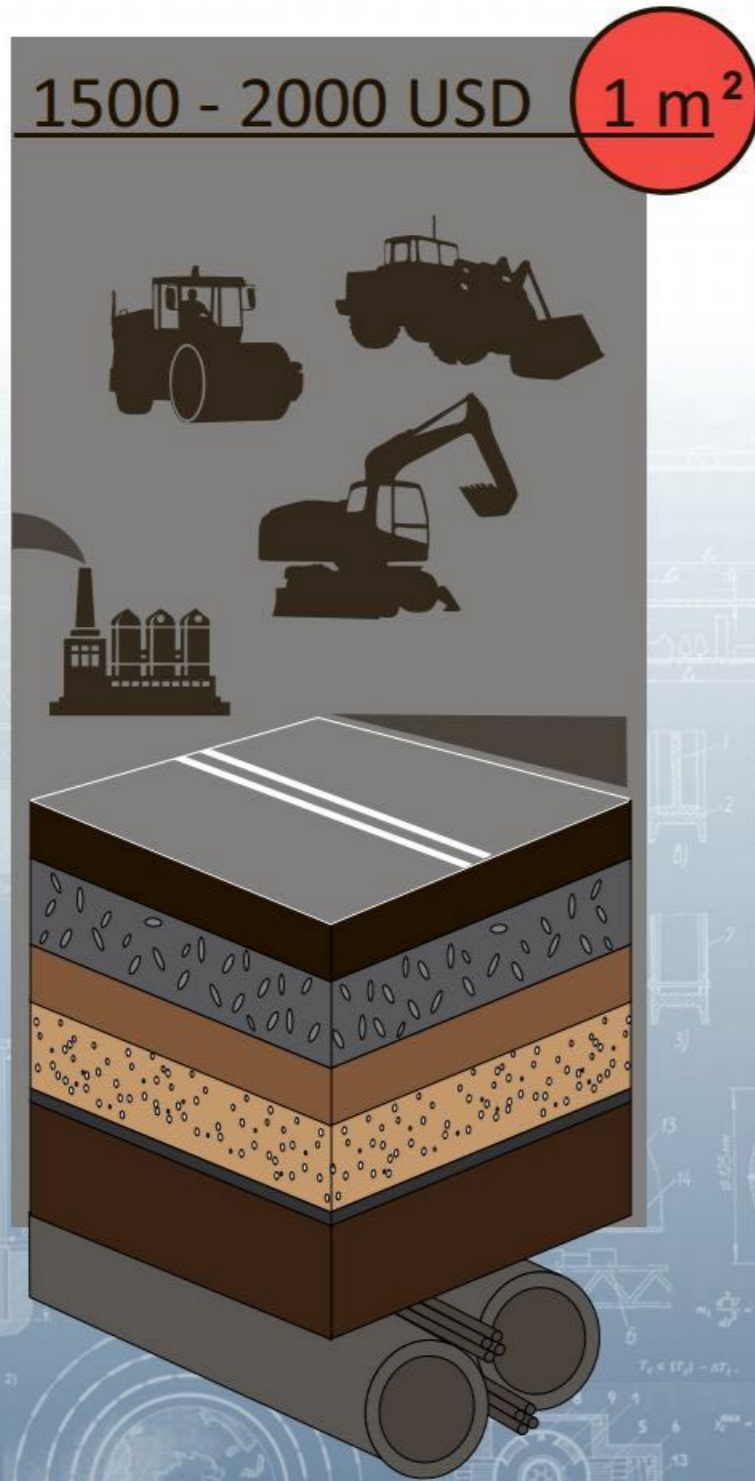



Fully automated (unmanned) overhead urban transport, clean and silent, elevated high above the ground, will provide the highest level of safety and comfort



High level of transport, environment safety and anti-terrorist security, as there are no intersections, pedestrian crossings, and oncoming traffic

